

50x150 beam extrusion type MA1-3

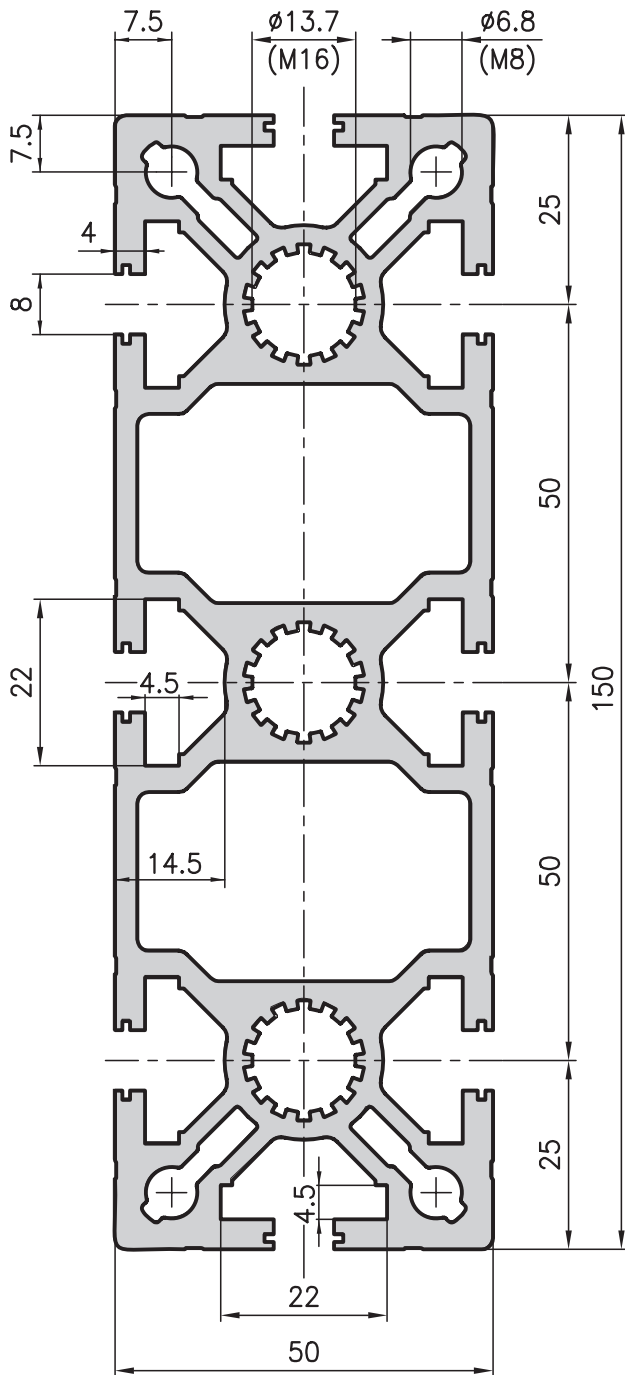

Application

As the name suggests, this extrusion is mainly used to support heavy loads because of its excellent load-bearing characteristics. However, it is also an effective manifold extrusion.

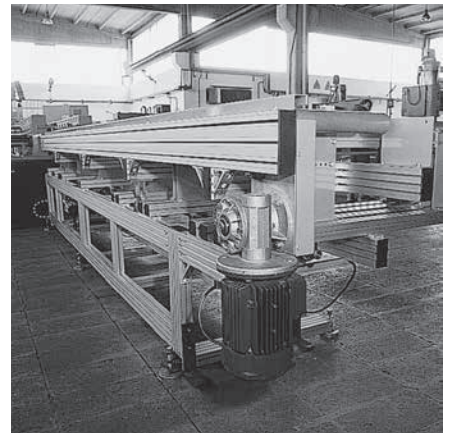
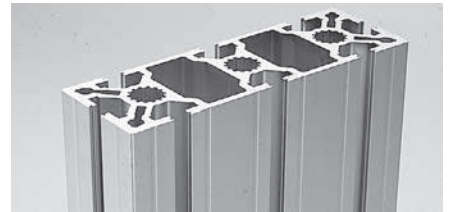

Technical data

I_x	=	608.31 cm ⁴
I_y	=	73.56 cm ⁴
W_x	=	81.11 cm ³
W_y	=	29.42 cm ³
Cross-section area	=	26.04 cm ²
Weight	=	7.1 kg/m

Order data

Order number

50x150 bearing extrusion	
Standard length 5000 mm	MA1-3-00/5000
Standard length 6000 mm	MA1-3-01/6000
50x150 bearing extrusion	
Cut to length	MA1-3-02-02/...
Extra machining	Pages 57-61